

KNEER · SÜD
FENSTER

Lived Vision

ENTRANCE DOORS
PRIME MODELS

2023

WOOD

PRIME MODELS 2023

Sophisticated front doors

The decisive factor for your well-considered purchase decision is certainly the appearance. The spark must jump over. Whether modern, classic, purist or charming - the front door must suit you and the style of your house. Wood front doors from KNEER-SÜDFENSTER are not only beautiful to look at and inviting, but also convince through inner values such as a robust construction, high security and good thermal insulation.

An innovative, technically mature front door fulfills its tasks for many years and looks very good at the same time!

ENTRANCE DOORS
CATEGORY PREMIUM⁺

FROM PAGE 4

ENTRANCE DOORS
CATEGORY PREMIUM

FROM PAGE 8

ENTRANCE DOORS
CATEGORY BASIC

PAGE 17

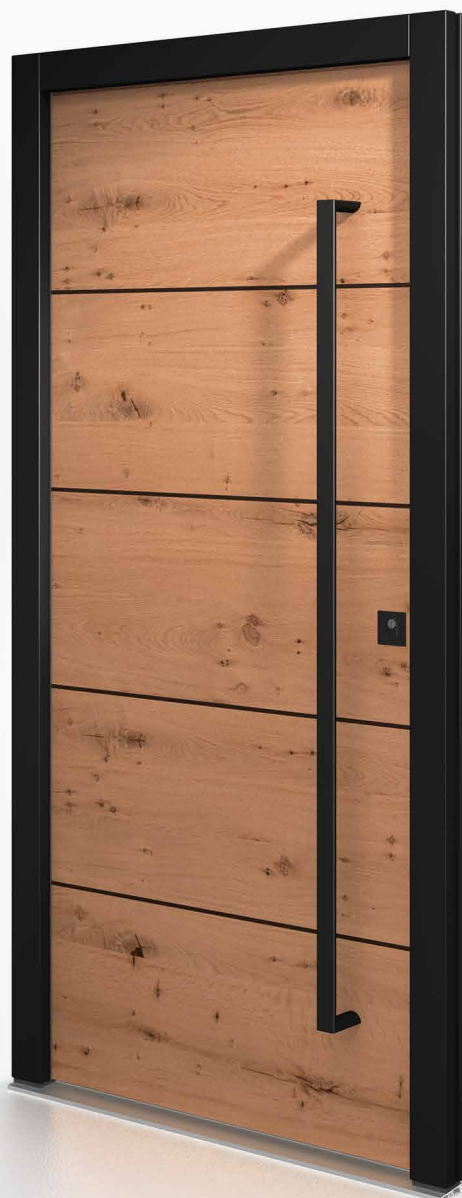

Welcome to Kneer-Südfenster

For 90 years the family business KNEER-SÜDFENSTER has been producing high-quality building elements for demanding clients from aluminum-wood, wood, aluminum, aluminum-plastic and plastic.

Around 800 employees manufacture windows, lift-and-slide doors, mullion-transom facades and entrance doors according to the latest findings in the highest quality for customers all over the world.



ENTRANCE DOORS MODELS	4
WOOD TYPES & COLOURS	18
GLAZING	19
HANDLE BARS	20
INTERIOR HANDLES & EXTERIOR ROSETTES	21
BLACK EQUIPMENT	22
SMART-HOME	23
SPECIAL EQUIPMENT	24
SAFETY TECHNOLOGY	26
TECHNICAL DATA	28
ALSO AVAILABLE	32
MODEL OVERVIEW	34

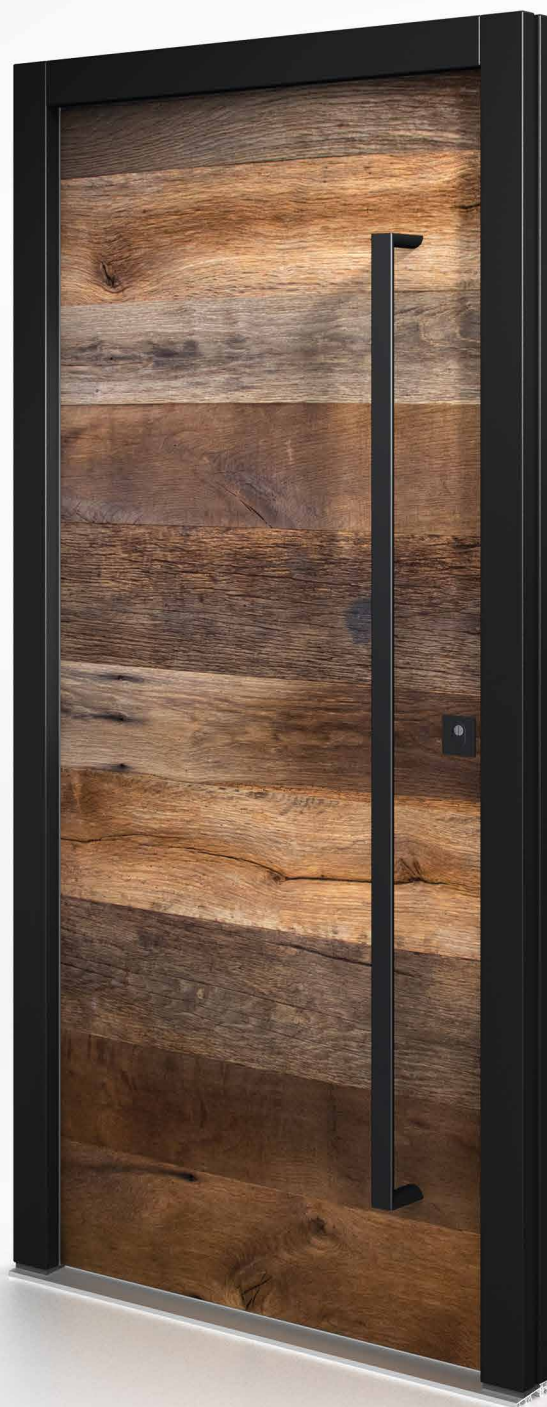

HT A 23-337

Standard Equipment
handle BA 3058
plano-rosette angular BA 3520

*The door leaves are unique,
extreme colour deviations can
occur due to the raw material*

NATURAL, RUSTIC, ORIGINAL

Feel the breath of past centuries: if this entrance door could tell stories!
It would certainly be interesting to learn where this oak was once planted,
how it survived the wars and what was built and carpentered from its wood.

Standard Equipment

*automatic-lock with daytime function | fully concealed hinges | frame wood type oak, colour RAL 9005 jet black
door leaf outside oak old wood | door leaf inside oak knotty cross veneered brushed | handle and rosettes freely selectable*



please consider, we recommend to install the door only in a protected area for example recessed or roofed or porched in order to avoid a direct weathering through rain or sunlight!

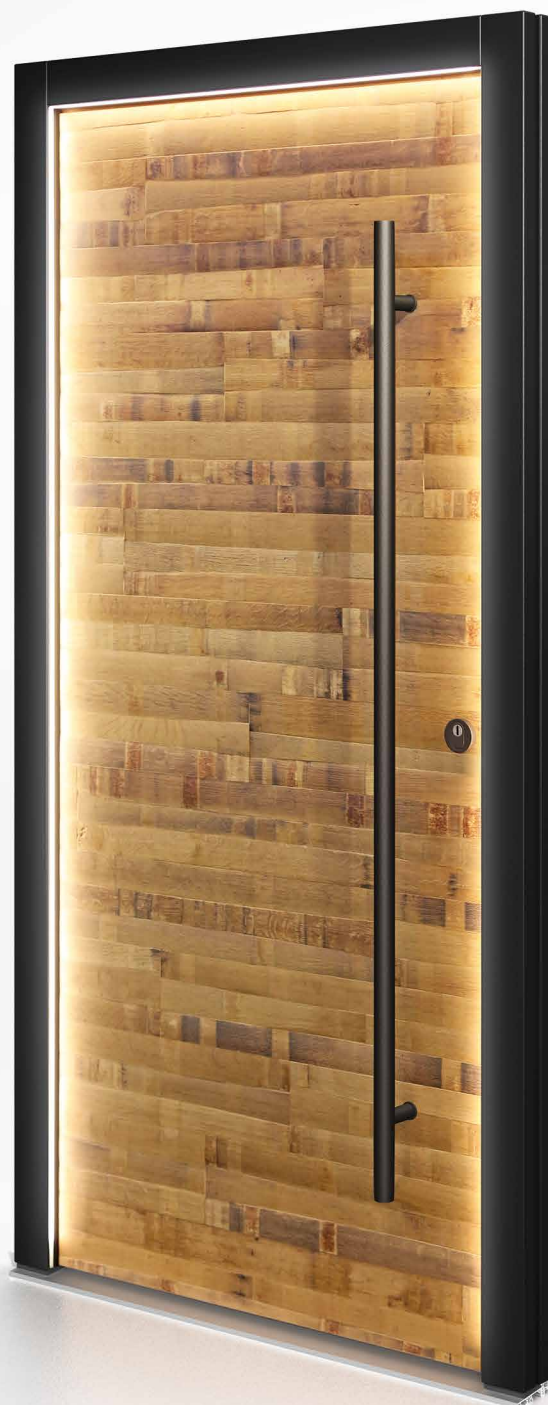

HT A 23-338

Standard Equipment
handle BA 3062
round rosette BA 3518
LED lighting

*The door leaves are unique,
extreme colour deviations can
occur due to the raw material*

UNMISTAKABLE APPEARANCE

Aged from wine: the entrance door „barrel oak“, classic craftsman art translated in a modern way. A unique entrance door with unmistakable appearance for discerning builders with a faible for the special.

Standard Equipment

automatic-lock with daytime function | fully concealed hinges | frame wood type oak, colour RAL 9005 jet black | door leaf outside barrel oak | door leaf inside oak OEL 27-10 knotty cross veneered brushed | round rosette BA 3518 | handle freely selectable

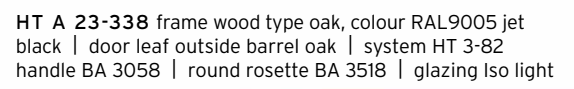

7

PREMIUM

EQUIPMENT
ALSO AVAILABLE IN
STAINLESS STEEL

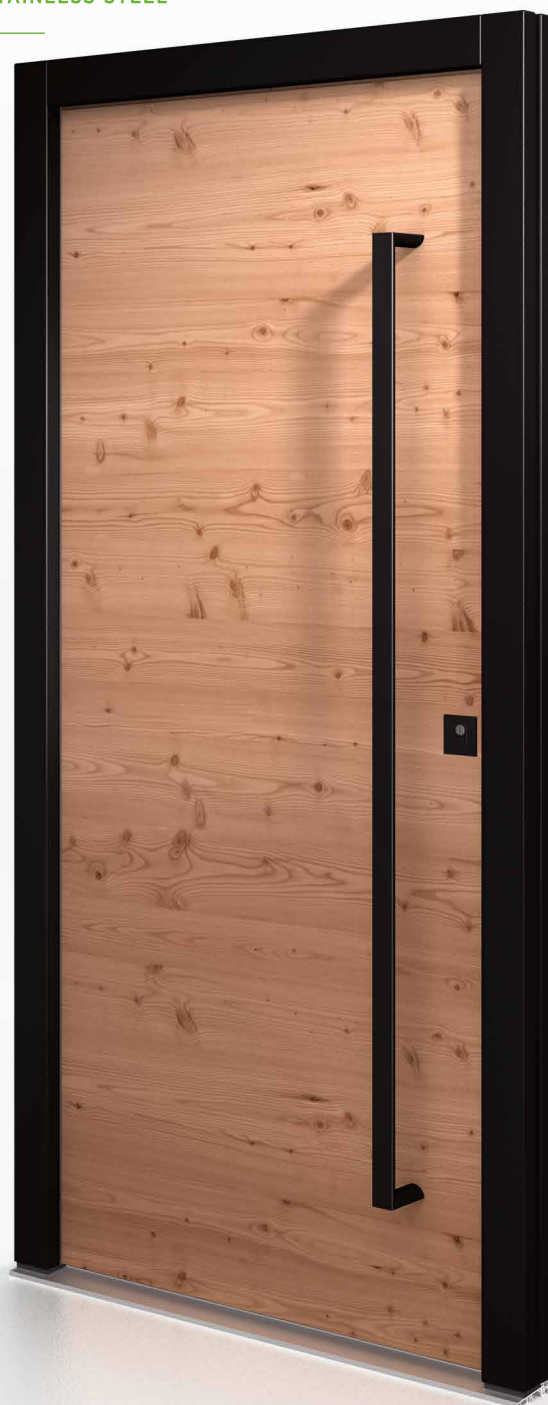

HT A 23-327

door leaf larch brushed light
frame wood type meranti,
colour RAL 9005 jet black
handle BA 3058
plano-rosette angular BA 3520

*Please consider the door
contains optional equipment*

EQUIPMENT
ALSO AVAILABLE IN
STAINLESS STEEL

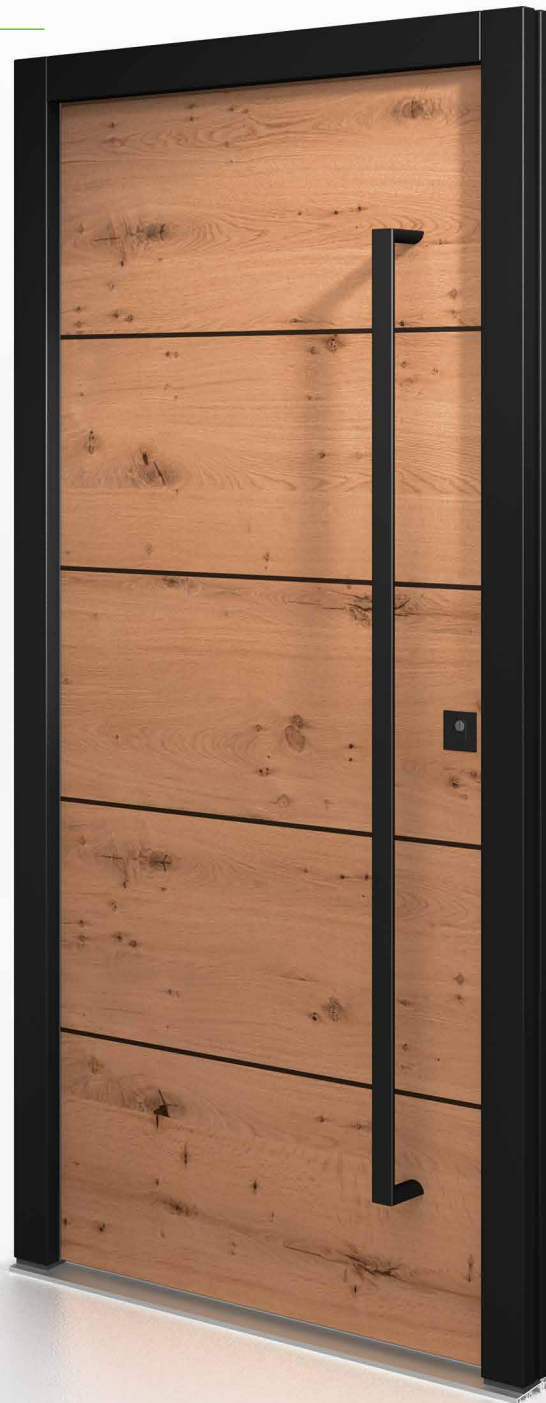

HT A 23-328

door leaf oak brushed light
frame wood type meranti,
colour RAL 9005 jet black
jet black stripes
handle BA 3058
plano-rosette angular BA 3520

*Please consider the door
contains optional equipment*

PREMIUM

EQUIPMENT
ALSO AVAILABLE IN
STAINLESS STEEL

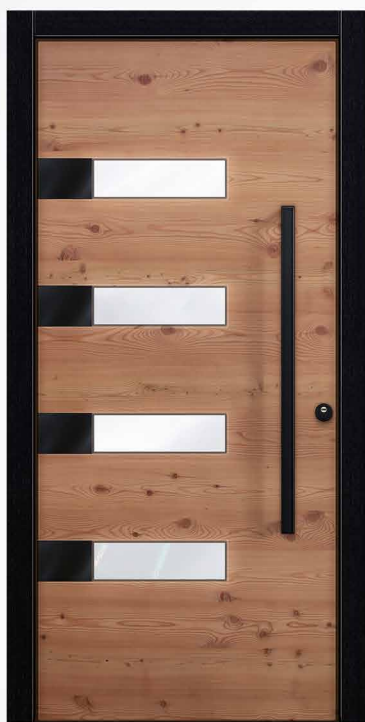

HTA 23-329

door leaf larch brushed light
frame wood type meranti,
colour RAL 9005 jet black
glazing satinato white | handle BA 3060
round rosette BA 3518
jet black applications



HTA 23-331

door leaf oak brushed light
frame wood type meranti,
colour RAL 9005 jet black
glazing satinato white | handle BA 3060
round rosette BA 3518

NATURAL WOOD SURFACES

The door leaf can be designed in the types of wood oak and larch. The cross veneer is executed brushed. The color differences and rough branches are deliberately emphasized. The veneer of the surface is much more knotty and lively like that of the oak. The expression of the individual veneers can nevertheless vary. The frame is executed in a covering shade, so that on the one hand the traditional and on the other hand modern look of the door comes into its own. Since the top coat on the door leaf has only a very low pigmentation, a constructive weather protection of the door is necessary.

The following doors are available with brushed cross veneers:

HT A 23-327 | HT A 23-328 | HT A 23-329 | HT A 23-331



LARCH BRUSHED
light & dark



OAK BRUSHED
light & dark



HT A 23-327 frame wood type meranti, colour RAL 9005
jet black | door leaf oak brushed dark | system HT 3-82
handle BA 3060 | round rosette BA 3518
glazing side lights Iso light

*please consider, we recommend to install the door only in a
protected area for example recessed or roofed or porched in
order to avoid a direct weathering through rain or sunlight!*

PREMIUM

EQUIPMENT
ALSO AVAILABLE IN
STAINLESS STEEL



HT A 23-307

wood type pine, colour NCS-S-1500-N | glazing satinato white
grooves | handle BA 3063 | round rosette BA 3518



HT A 23-311

wood type pine, colour NCS-S-1500-N | glazing satinato white
grooves | handle BA 3063 | round rosette BA 3518



HT A 23-318

wood type meranti, colour RAL 7037 dusty grey
glazing satinato white | grooves | jet black base plate
handle BA 3060 | plano-rosette angular BA 3520



HT A 23-325

wood type meranti, colour RAL 7037 dusty grey
glazing satinato white | grooves
handle BA 3063 | round rosette BA 3518

HT A 23-318 wood type pine, colour RAL9016 traffic white | grooves
handle BA 3060 | plano-rosette BA 3520 | glazing satinato white



PREMIUM

EQUIPMENT
ALSO AVAILABLE IN
JET BLACK



HT A 23-301

wood type pine, colour NCS-S-1500-N
long plate 507 H | glazing satinato white



HT A 23-316

wood type pine, colour NCS-S-1500-N
long plate 507 H | glazing satinato white



HT A 23-333

wood type pine, colour NCS-S-5005-Y20R
long plate 507 H | glazing satinato white



HT A 23-334

wood type pine, colour NCS-S-5005-Y20R
long plate 507 H | glazing satinato white
glued dividers



PREMIUM



HT A 23-302

wood type spruce, colour NCS-S-5005-Y20R
long plate 507 H | glazing satinato white
glued dividers



HT A 23-305

wood type spruce, colour NCS-S-5005-Y20R
handle BA 3009 | stainless steel base plate

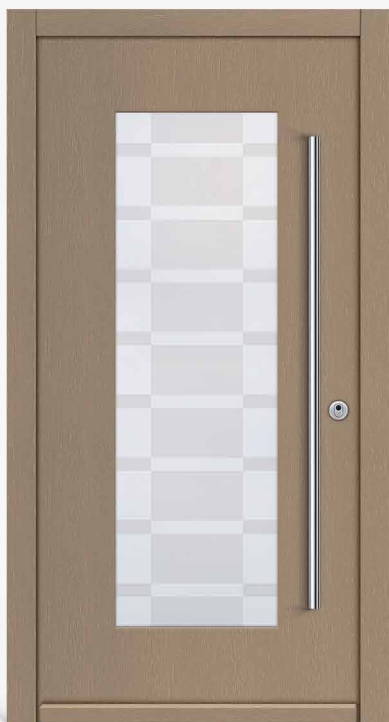

HT A 23-321

wood type spruce, colour NCS-S-5005-Y20R
handle BA 3009 | glass partially sandblasted



HT A 23-335

wood type spruce, colour NCS-S-5005-Y20R
handle BA 3009 | grooves

BASIC

ALL MODELS
ONLY WITH THE SHOWN HANDLES
OR LONG PLATES AVAILABLE



HT A 23-340

wood type pine, colour NCS-S-5005-Y20R
glazing satinato white | handle BA 3066, 1000 mm



HT A 23-341

wood type pine, colour NCS-S-5005-Y20R
glazing satinato white | handle BA 3066, 1000 mm



HT A 23-342

wood type pine, colour NCS-S-5005-Y20R
glazing satinato white | handle BA 3066, 1000 mm



HT A 23-343

wood type pine, colour NCS-S-5005-Y20R
glazing satinato white | handle BA 3066, 1000 mm

WOOD TYPES & COLOURS



PINE
LAS-12-09



PINE
LAS-16-09



PINE
LAS-19-03



PINE
LAS-18-02



PINE
LAS-40-02



PINE
LAS-31-01



PINE
LAS-43-13



PINE
LAS-44-14



SPRUCE
LAS-30-12



SPRUCE
LAS-46-13



SPRUCE
LAS-29-13



SPRUCE
LAS-45-13



MERANTI
LAS-43-13



MERANTI
LAS-44-14



MERANTI
LAS-45-13



MERANTI
LAS-46-13



MERANTI
LAS-35-08



MERANTI
LAS-33-01



MERANTI
LAS-31-01



MERANTI
LAS-32-01



MERANTI
LAS-40-02



MERANTI
NCS-S-7005-Y50R

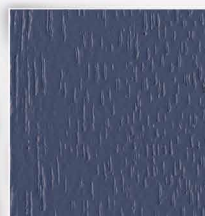

MERANTI
NCS-S-6020-R80B



MERANTI
NCS-S-8005-R80B



PINE | MERANTI | SPRUCE
NCS-S-1500-N



PINE | MERANTI | SPRUCE
NCS-S-2005-Y20R



PINE | MERANTI | SPRUCE
NCS-S-5005-Y20R



PINE | MERANTI | SPRUCE
NCS-S-5020-G30Y



MERANTI
NCS-S-5040-Y90R



PINE | MERANTI | SPRUCE
RAL-9016 traffic white

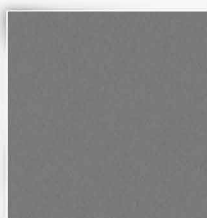

MERANTI | SPRUCE
RAL-7037 dusty grey



MERANTI
RAL-7015 schiefergrau



MERANTI
RAL-7016 anthracite grey



MERANTI
RAL-6009 moss green

GLAZING

To make your new front door even more individual, we offer special glasses for you to choose from. In addition to Iso light, we also offer various ornamental glass types. Or would you prefer Satinato white with a clear edge? Very elegant!



SATINATO WHITE*



SATINATO WITH CLEAR EDGE



CHINCHILLA WHITE*



MASTERCARRE WHITE*



SILVIT WHITE



GOTHIK WHITE



MADRAS PAVE WHITE



MADRAS UADI WHITE



BAROCK WHITE



ON REQUEST WITH MIRROR ON THE INSIDE

All doors without glass cutout are perfectly suitable for designing with a large mirror (approx. 30 cm wide). This is a decorative as well as practical design and changes the design in the entrance area.

The following doors are available with mirror:

HT A 23-305 | HT A 23-327 | HT A 23-328 | HT A 23-335

HT A 23-337 | HT A 23-338 | **against surcharge**

HANDLE BARS



HANDLE BAR HALF-ROUND

material: stainless steel
dimension and type:

- 1500 mm - BA 3028
- 1300 mm - BA 3027
- 1000 mm - BA 3026
- 800 mm - BA 3025



NOTE

For **PREMIUM** and **PREMIUM+** entrance doors you can choose between these handle bars

HANDLE BAR ROUND

material: stainless steel
dimension and type:

- 1500 mm - BA 3012
- 1300 mm - BA 3009
- 1000 mm - BA 3024
- 800 mm - BA 3023



KNOB ROUND

material: stainless steel
type: BA 3006

LONG PLATES & BASE PLATE



LONG PLATE

material: stainless steel
type: BA 3510



LONG PLATE

material: steelgrey
type: 507 H



BASE PLATE

material: stainless steel

The following doors are only available with **LONG PLATE** BA 3510, BA 3511 or 507 H:
HT A 23-301 | HT A 23-302 | HT A 23-316 | HT A 23-333 | HT A 23-334

The following doors are available with **BASE PLATE**:
HT A 23-307 | HT A 23-311 | HT A 23-321 | HT A 23-325 | HT A 23-327
HT A 23-328 | HT A 23-329 | HT A 23-331 | HT A 23-335

INTERIOR HANDLES & EXTERIOR ROSETTES

PREMIUM and **BASIC** front doors are standardly equipped with stainless steel fittings and interior handle BA 3503. On request, a handle can be selected on the outside instead of the handle bar. The outside lever handle is identical with the inside lever handle. You will receive 5 keys in the standard.



INTERIOR HANDLE ROUND

material: stainless steel
type: BA 3502



INTERIOR HANDLE ANGULAR

material: stainless steel
type: BA 3506



PROFILE CYLINDER

with drilling protection
and 5 reversible keys



PLANO-ROSETTE ROUND

with interior handle round
material: stainless steel
type: BA 3522



PLANO-ROSETTE ANGULAR

with interior handle angular
material: stainless steel
type: BA 3523

BLACK EQUIPMENT

Black MAGIC

Fully on trend:

Accessories in an elegant very intense black. Mysterious, traditional and fascinating. Magical forces captivate your visitors and convey an enchanting, sparkling atmosphere of well-being.

Surprise family, friends and acquaintances with a high quality entrance door made especially for you, including the most state-of-the-art technology.

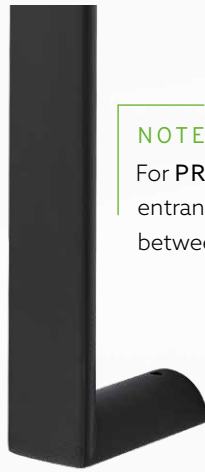

NOTE

For **PREMIUM** and **PREMIUM+** entrance doors you can choose between these handle bars



HANDLE BAR HALF-ROUND

dimension and type:

1500 mm - BA 3058
1300 mm - BA 3059
1000 mm - BA 3060
800 mm - BA 3061

HANDLE BAR ROUND

dimension and type:

1500 mm - BA 3062
1300 mm - BA 3063
1000 mm - BA 3064
800 mm - BA 3065



INTERIOR HANDLE ROUND

cylinder cover: round rosette
type: BA 3518



LONG PLATE

type: BA 3511

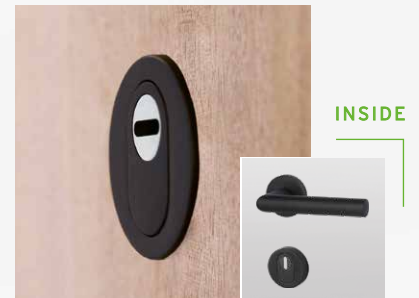

PLANO-ROSETTE ROUND

with interior handle round
type: BA 3519



PLANO-ROSETTE ANGULAR

with interior handle angular
type: BA 3520



APPLICATION / STIPES



HINGES / BASE PLATE

FRAME in RAL 9005 jet black **without surcharge**
(only possible in meranti or oak)

SMART-HOME

SAFETY BEGINS OUTSIDE THE DOOR

SmartConnect door is a modern, smart video door intercom system that opens up new possibilities for you. Via tablet or smartphone you can always and everywhere get in touch with your visitors, even if you are not at home. The small and discreet door module also contains a smart home server that can be used to manage users and access authorizations in addition to opening the door.

NOTE

SmartConnect door is only possible with **PREMIUM** and **PREMIUM+** entrance doors.

ATTENTION SmartConnect door is not possible with HT A 23-338!



COMFORTABLE OPERABILITY

- ✓ Intuitive operation of the door intercom system via smartphone app
- ✓ Location-independent interaction with visitors - authorized mobile devices receive a push message as soon as the bell is rung
- ✓ Individual user administration with time profiles



HIGH SECURITY

- ✓ High system security through secure encryption and user accounts
- ✓ You can see your visitors, speak with them, open the door - a log of everything that happens in front of your entrance door
- ✓ Additional security: A presence is suggested to the person ringing the bell and you can see who is at your entrance door at all times

CAMERA

LANGUAGE MODUL

TOUCH-BELL

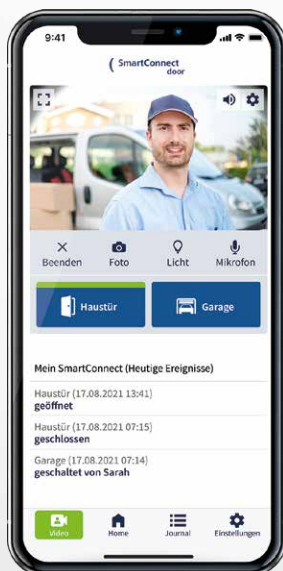

NOTE

For SmartConnect door, the door must be near a WLAN network

SPECIAL EQUIPMENT

ACCESS OPTIONS

All doors are equipped as standard with an automatic lock (without E-opener).

By pulling the door, the latch bolts at the top and bottom of the door automatically move 20 mm into the bolting bar. As a result, the door is always locked - without locking with the key. A day trap (also called snapper or latch) is also integrated in the lock, however, the automatic locking must be deactivated for use.

1 E-OPENER

Electric door opener - for using, the automatic lock has to be deactivated manually. The E-opener is integrated in the face plate.

- ✓ Easy opening of the door by actuation of e.g. the domestic intercom system
- ✓ No need to walk to the door

2 AUTOMATIC LOCK WITH M-OPENER

Door opener with motor-driven release - By pulling the door closed the multipoint lock will be activated without locking it. Releasing is done by pressing the handle or for instance by a domestic intercom system. Electrical opening options such as fingerprint or domestic intercom system are overridden by manual relocking.

- ✓ Maximum security without locking
- ✓ The automatic and the motorised locking complement each other
- ✓ Ideal for access system in single and multi-family houses

3 FULL MOTORIZED LOCK

Opening and closing is motorized - as if by magic. As soon as the door falls into the lock, the lock independently closed, without any manual closing. The opening of the door is comfortably motorized via door opener the intercom system or via access systems.

- ✓ Maximum comfort and security
- ✓ Increased tightness
- ✓ Panic function as standard, opening the door from inside is always guaranteed

FULLY CONCEALED HINGES

All **PREMIUM+** front doors are equipped with concealed hinges as standard.

You have the possibility to upgrade all **PREMIUM** and **BASIC** front doors with concealed hinges.

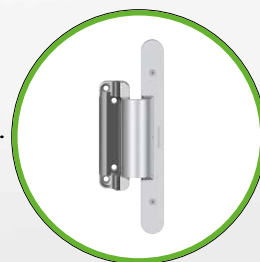

FINGERPRINT ACCESS SYSTEM INCLUDING M-OPENER



The fingerprint includes the M-opener listed above. The automatic locking and motorized unlocking is thus ensured and thus increases the safety. Electrical opening options such as fingerprint or domestic intercom system are overridden by manual relocking.

ALSO
AVAILABLE IN
JET BLACK



- ✓ comfortable operation, you don't have to carry a key
- ✓ external access is not only possible via the key but also via the fingerprint - you have the choice
- ✓ the door is always closed and thus provides maximum security
- ✓ our fingers are unique and cannot be replicated or get lost, the fingerprint ages with you
- ✓ pull the taught fi nger over the scanner, the green light will illuminate and the door will unlock



DETAIL



1 INTEGRATED IN THE DOOR LEAF

fingerprint in jet black



DETAIL



2 INTEGRATED IN THE HANDLE BAR

Installation height of the fingerprint approx. between 1350 mm and 1600 mm depending on the door height and model. Push bar angular 40 x 20 mm with:

push bar length 1300 mm	-	BA 3036
push bar length 1500 mm	-	BA 3037

OPTIONALLY SINGLE SPACE MONITORING

With this variant you have the option to delete or shut down individual fingers. Controllable only via App (if you have a smartphone with Bluetooth-function).

SAFETY TECHNOLOGY

SECURITY AND SAFETY FOR YOUR HOME

Your new entrance door should be inviting for visitors and deterrent for burglars.

First and foremost, it must guarantee safety because burglars choose this way more and more often.

Even with the basic equipment we therefore attach great importance to the solid safety mechanism.





SAFETY COMPONENTS

STANDARD EQUIPMENT

- 1 Lock tested corresponding to security class RC 2: when closing the door the latch bolts drive 20 mm into the bolting bar via a magnetic impuls at the top and bottom of the door. Therefore the door is always closed - without re-closing with a key.
- 2 The main bolt can be locked with a key turn - the lever blocks for control purposes, as a child safety lock and for maximum security.
- 3 Continuous bolting bar: protection against prying on the lock side
- 4 Cylinder with drill protection
- 5 5 Interior handle in stainless steel with exterior cylinder cover (ES1-part): serves as a pull protection for the cylinder
- 6 Stable roller conveyor: triple security on the hinge side

ON REQUEST THE PLUS IN SAFETY

- 7 P4A safety glazing: One pane consists of a composite of two panes with integrated security foil. Furthermore, the glazing is glued circumferential with a special adhesive in the glass cut-out. Thus, the glass connection is secured. | Safety execution RC 2 **against surcharge**

The status **RC 2 TESTED** achieve the following front doors

- ✓ Without glass cut-out through standard equipment: HT A 23-305 | HT A 23-327 | HT A 23-328 | HT A 23-335
- ✓ Through the use of an additional P4A protective glazing:
HT A 23-307 | HT A 23-311 | HT A 23-318 | HT A 23-321 | HT A 23-325 | HT A 23-329 | HT A 23-331
- ✓ For front doors of series 3 you can get an RC 2 test certificate as an option | **against surcharge**

TECHNICAL DATA

MATERIAL	wood
SYSTEM	HT 1-82 construction door frame and leaf are profiled or straight HT 2-82 construction door frame and leaf are profiled or straight
GASKETS	2 pieces
GLAZING	triple glazing, with warm edge
WOOD TYPE	pine, meranti or spruce
WOOD SURFACE	4-layer colour application, colours according to KNEER-SÜDFENSTER colour chart
LOCK	multiple locking with daytime function, without E-opener but with day release
CYLINDER	profile cylinder with emergency and danger function, drill protection and 5 keys
HINGES	3 pieces of 3-piece bands (asymmetric band seat)
MAX. SIZE	1150 x 2250 mm frame outer dimension
MIN. SIZE	980 x 1980 mm frame outer dimension

U_D-VALUE HT 1-82 *

MODEL	CATEGORY	U _D -VALUE PINE/MER	U _D -VALUE SPRUCE
HT A 23-333	PREMIUM	0,97 W/m²K	0,91 W/m²K
HT A 23-334	PREMIUM	0,96 W/m²K	0,91 W/m²K
HT A 23-302	PREMIUM	1,0 W/m²K	0,96 W/m²K
HT A 23-340	BASIC	0,95 W/m²K	0,90 W/m²K
HT A 23-341	BASIC	0,98 W/m²K	0,94 W/m²K
HT A 23-342	BASIC	1,0 W/m²K	0,96 W/m²K
HT A 23-343	BASIC	1,0 W/m²K	0,98 W/m²K

U_D-VALUE HT 2-82 *

MODEL	CATEGORY	U _D -VALUE PINE/MER	U _D -VALUE SPRUCE
HT A 23-301	PREMIUM	1,0 W/m²K	0,97 W/m²K
HT A 23-316	PREMIUM	1,0 W/m²K	0,97 W/m²K

HT 1-82

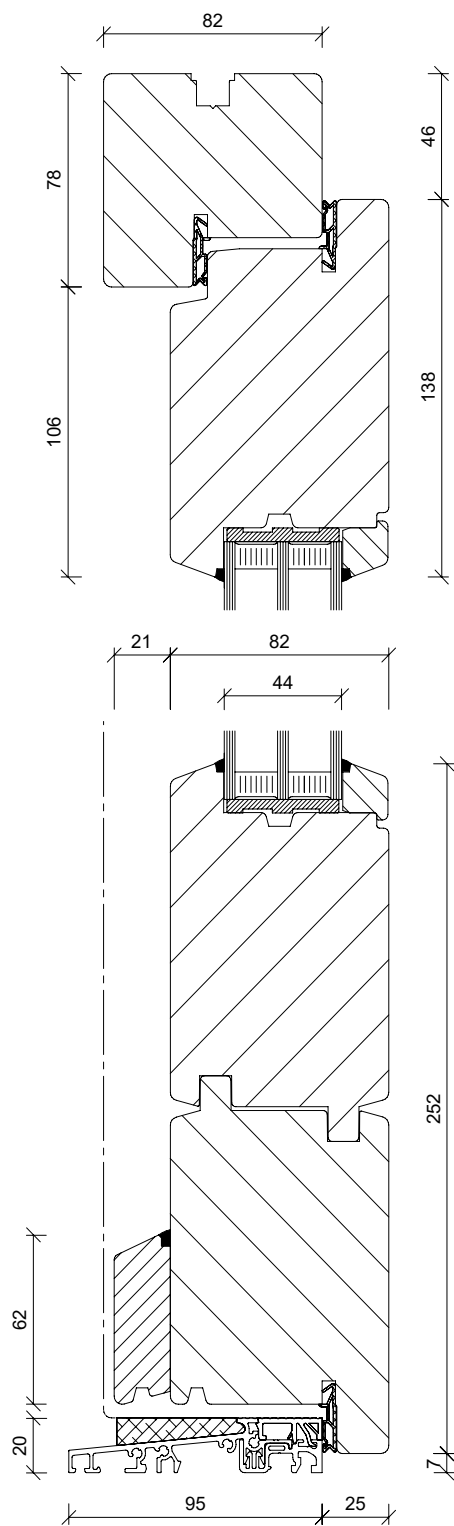

HT 2-82

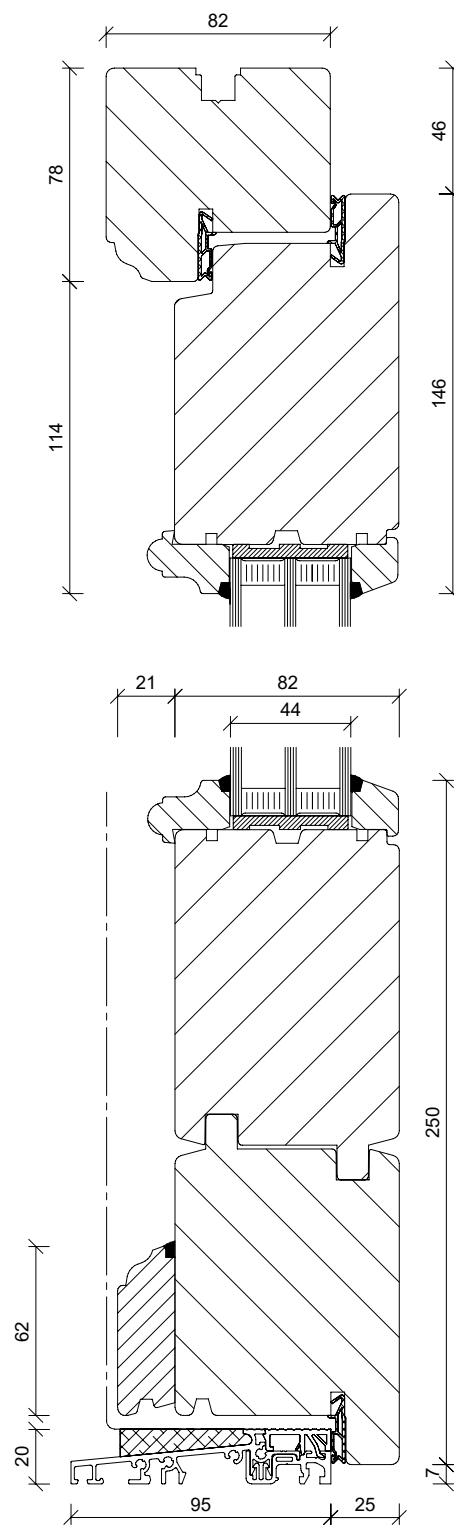

TECHNICAL DATA

MATERIAL	wood
SYSTEM	HT 3-82 full leaf door frame 82 mm, leaf 78 mm
GASKETS	2 pieces
GLAZING	triple glazing, with warm edge
WOOD TYPE	pine, meranti or spruce
WOOD SURFACE	4-layer colour application, colours according to KNEER-SÜDFENSTER colour chart
LOCK	multiple locking with daytime function, without E-opener but with day release
CYLINDER	profile cylinder with emergency and danger function, drill protection and 5 keys
HINGES	3 pieces of 3-piece bands (asymmetric band seat)
MAX. SIZE	1150 x 2250 mm frame outer dimension
MIN. SIZE	980 x 1980 mm frame outer dimension

U_D-VALUE HT 3-82 *

MODEL	CATEGORY	U _D -VALUE OAK	U _D -VALUE PINE/MER	U _D -VALUE SPRUCE
HT A 23-337	PREMIUM⁺	1,0 W/m ² K	-	-
HT A 23-338	PREMIUM⁺	1,0 W/m ² K	-	-
HT A 23-307	PREMIUM	-	0,96 W/m ² K	0,91 W/m ² K
HT A 23-311	PREMIUM	-	0,95 W/m ² K	0,90 W/m ² K
HT A 23-318	PREMIUM	-	0,94 W/m ² K	0,89 W/m ² K
HT A 23-325	PREMIUM	-	0,95 W/m ² K	0,90 W/m ² K
HT A 23-327	PREMIUM	-	0,90 W/m ² K	0,86 W/m ² K
HT A 23-328	PREMIUM	-	0,90 W/m ² K	0,86 W/m ² K
HT A 23-329	PREMIUM	-	0,95 W/m ² K	0,91 W/m ² K
HT A 23-331	PREMIUM	-	0,95 W/m ² K	0,90 W/m ² K
HT A 23-305	PREMIUM	-	0,90 W/m ² K	0,86 W/m ² K
HT A 23-321	PREMIUM	-	0,96 W/m ² K	0,91 W/m ² K
HT A 23-335	PREMIUM	-	0,90 W/m ² K	0,86 W/m ² K

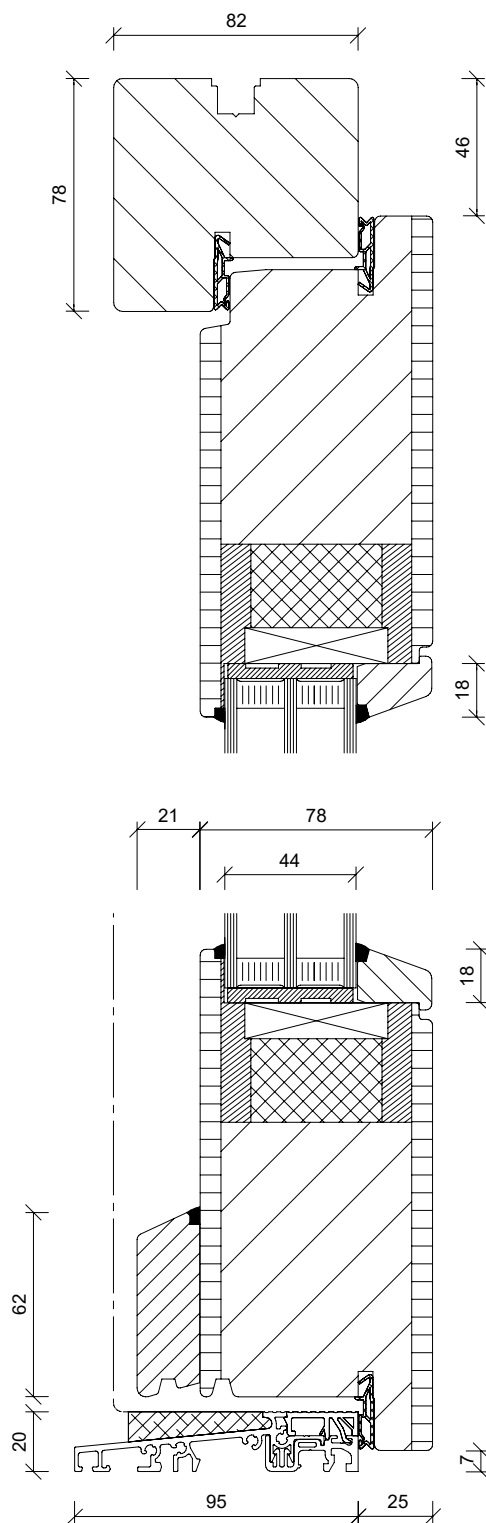

ALSO AVAILABLE

SIDE LIGHTS

ST A 1, ST A 2 and ST A 3 possible

(max. width 910 mm)

Pine, meranti and spruce possible

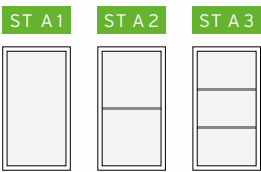

GLAZING

VSG 6 mm for entrance door (one side)

VSG 6 mm for side light (one side)

COLOURS

Entrance door and side light in RAL at choice

Entrance door inside different colour as outside

(one colour shade must be opaque)

Side light inside different colour as outside

(one colour shade must be opaque)

ACCESS OPTIONS

Electric opener

Automatic lock as multipoint locking with M-Opener

SECURITY / MISCELLANEOUS

Safety execution RC 2 for entrance door (tested)

Entrance door with higher security level*

Safety execution RC 2 for side lights (tested)

Mirror on the inside of the entrance door

LED lighting for HT A 23-338

Sandblasted glass with clear edge or clear stripes
(entrance door and/or side light) per door or side light

Entrance door or side light with coloured offset glass
rod outside (covering paint)

NOTE

There might be slight deviations in colour due to printing process.



MODEL OVERVIEW



P+ >

HTA 23-337
> page 4



HTA 23-338
> page 6



P >

HTA 23-327
> page 8



HTA 23-328
> page 9



HTA 23-329
> page 10



HTA 23-331
> page 10



HTA 23-307
> page 12



HTA 23-311
> page 12



HTA 23-318
> page 12



HTA 23-325
> page 12



HTA 23-301
> page 14



HTA 23-316
> page 14



HTA 23-333
> page 14



HTA 23-334
> page 14



HTA 23-302
> page 16



HTA 23-305
> page 16



HTA 23-321
> page 16



HTA 23-335
> page 16



B >

HTA 23-340
> page 17



HTA 23-341
> page 17



HTA 23-342
> page 17



HTA 23-343
> page 17

KNEER · SÜD **FENSTER**

Lived Vision



KNEER GmbH Fenster und Türen

Horst-Kneer-Straße 1
D-72589 Westerheim
phone: +49 (0) 7333 / 83-0
e-Mail: info@kneer.de

SÜD-FENSTERWERK GmbH & Co. Betriebs-KG

Rothenburger Straße 39
D-91625 Schnelldorf
phone: +49 (0) 7950 / 81-0
e-Mail: info@suedfenster.de

SÜD-BAUELEMENTE GmbH

Ludwig-Erhard-Straße 4
D-03238 Massen
phone: +49 (0) 3531 / 799-114
e-Mail: info@suedfenster.de



WWW.KNEER-SUEDFENSTER.DE

Your KNEER-SÜDFENSTER specialized dealer: